

Data Sheet for Freewheel Torque Sensor FWTS100



Technical Specification

Description	Value
Measuring Range	100Nm
Break-In Torque	200Nm
Voltage at Zero Torque	0.65V \pm 0.02V
Characteristic Curve Deviation	$<\pm 1\%$
RSU	$<\pm 1.5\%$ FS
Supply Voltage	6 to 16V
Nominal Supply	12VDC
Current Consumption in Measurement Mode	<25 mA
Nominal Sensor Signal Slope	40 \pm 0.5mV/Nm

Mating Connector PN:

Connector Crimp Housing: 51146-0300
Crimp Terminals: 50641-8141

Connector Pinout:

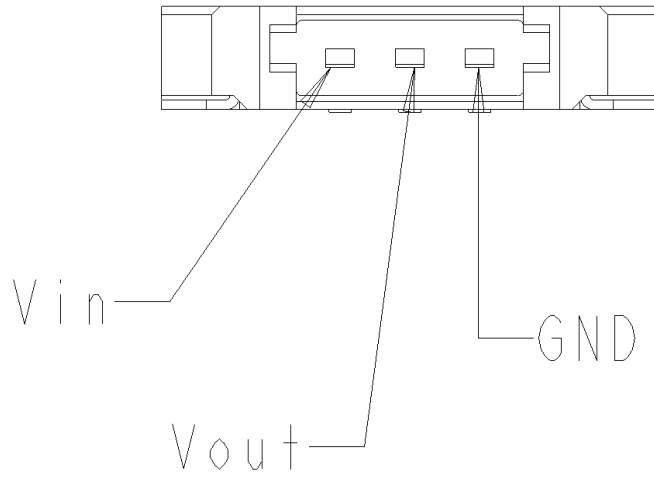

Overall Dimensions (mm):

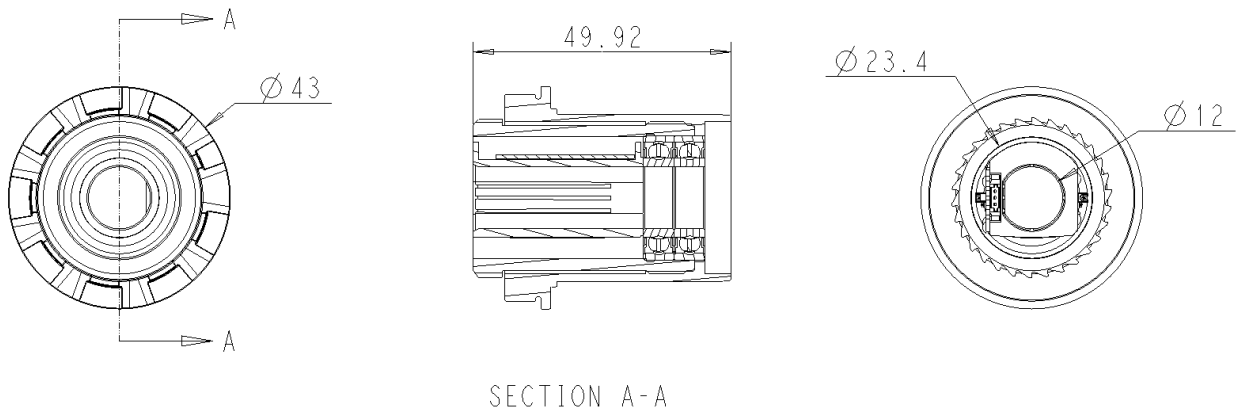

Cover Shaft:

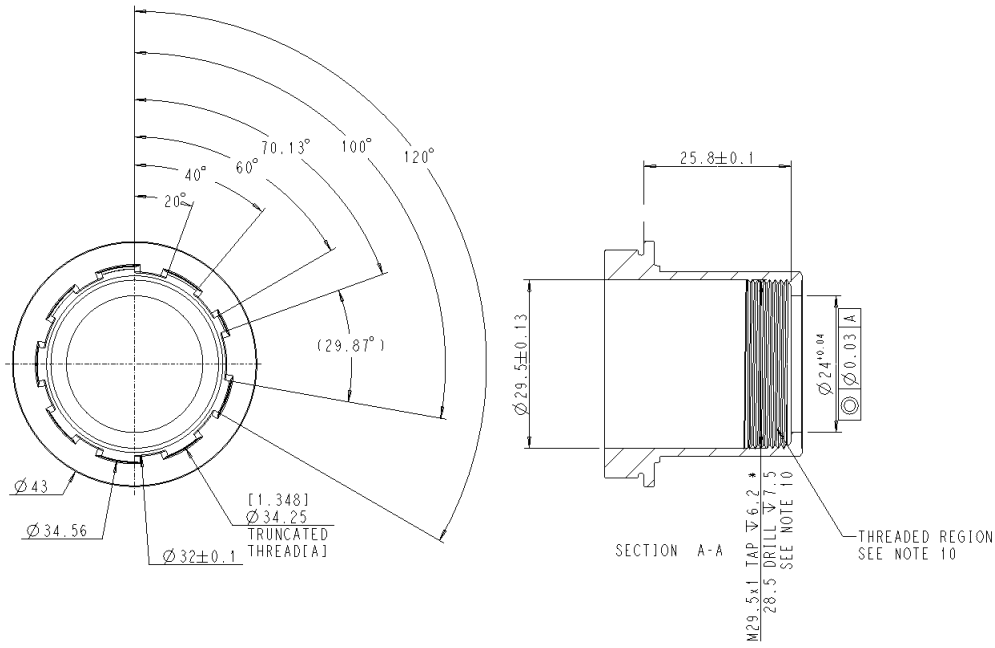

Inner Sensing Shaft:

